



GLEN DIMPLEX
NORDIC

ConfigR App
Updating SPC and SWT



Step 1

ConfigR can be downloaded on iOS via the AppStore or on Android via Google Play. Search for 'ConfigR'. Do not download ConfigR from any other locations/stores. Setup an account and add device.

There are 3ways to input the EUI64 info.

Step 2 includes all 3 methods.

Important info:

Devices that are manually updated via the ConfigR app, Will be removed from the connected smart home platform. After a completed update, simply power on and off device and then add the device back to your smart home platform.

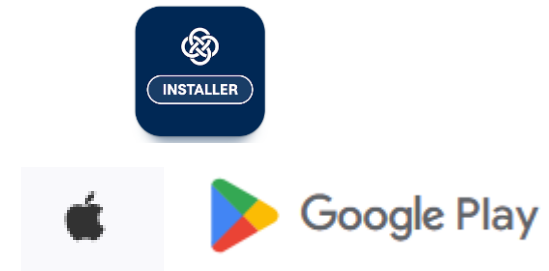

Step 2.1: Adding a device to config.

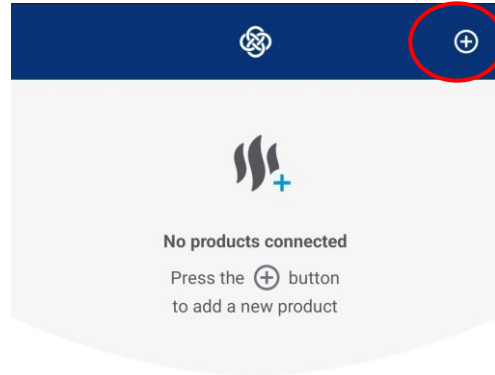

[See all products](#)

Press the + symbol in the top right corner

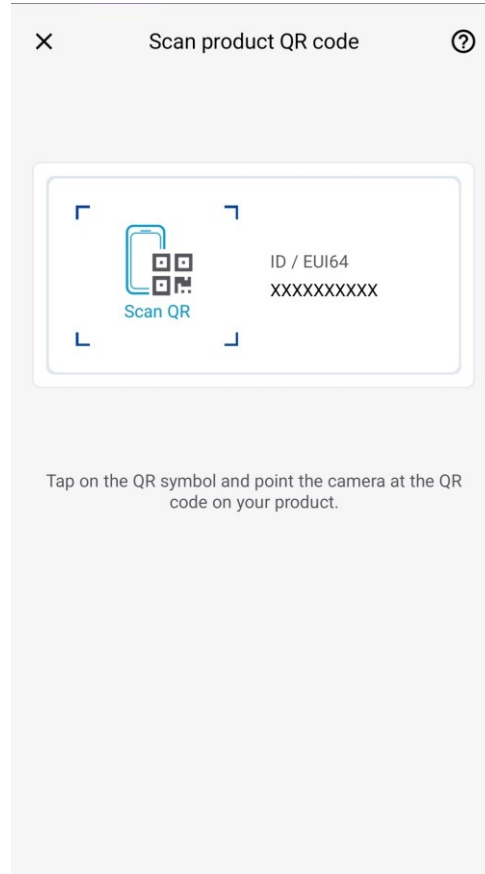

You will now be able to scan or manually enter the EUI64 code

The EUI64 information is on a sticker on the device. Scan the QR-code or manually input the code.



On SWT it is located on the backside of display unit

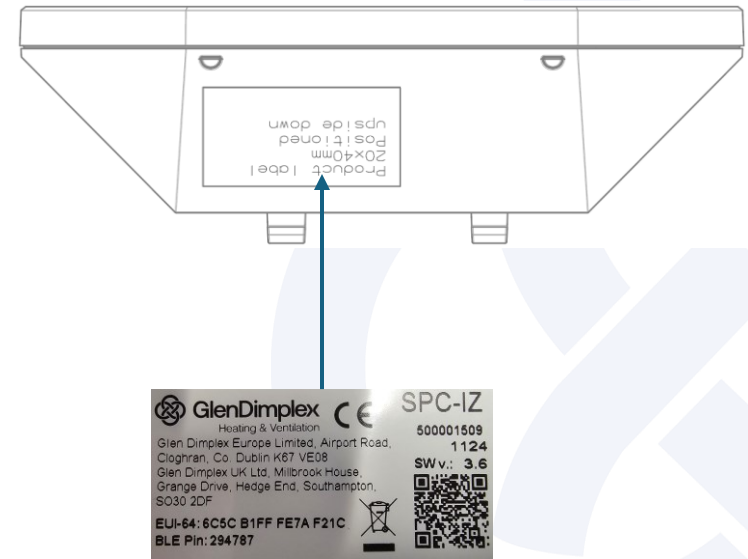

On SPC it is located on the backside of control unit

Step2.2: Adding a non connected device to configr.

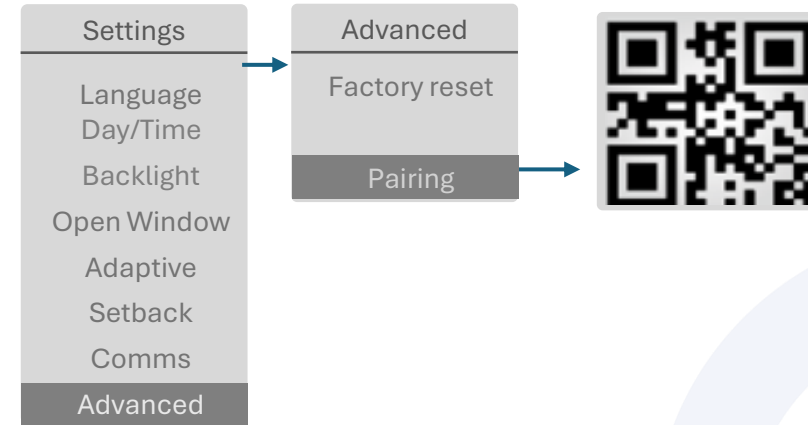
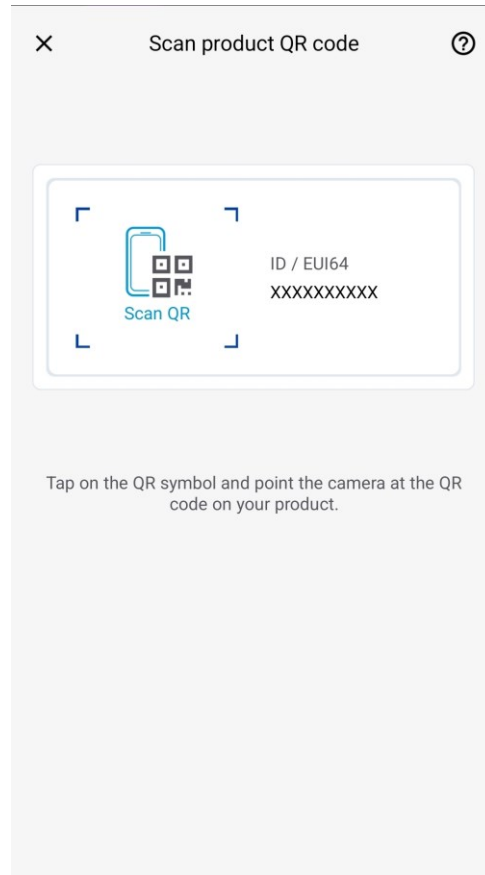
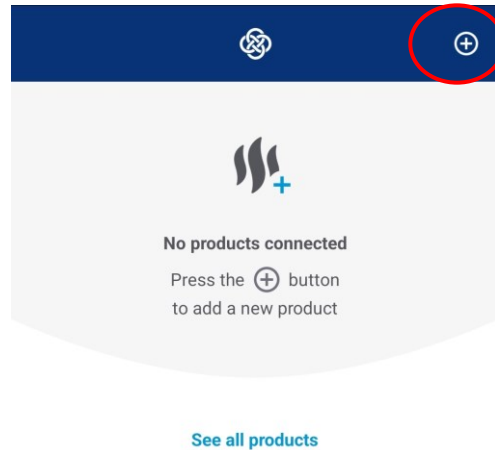

To be able to get the QR code in window, please access these settings and the then scan the QR code with the Config app



Press the + symbol in the top right corner

You will now be able to scan or manually enter the EUI64 code

Important: If a device is connected to a hub, the QR-code will not appear, please follow instruction on next page

Step 2.3: Adding a connected device to config.

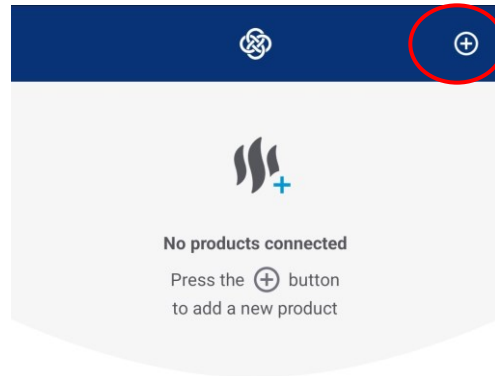

[See all products](#)

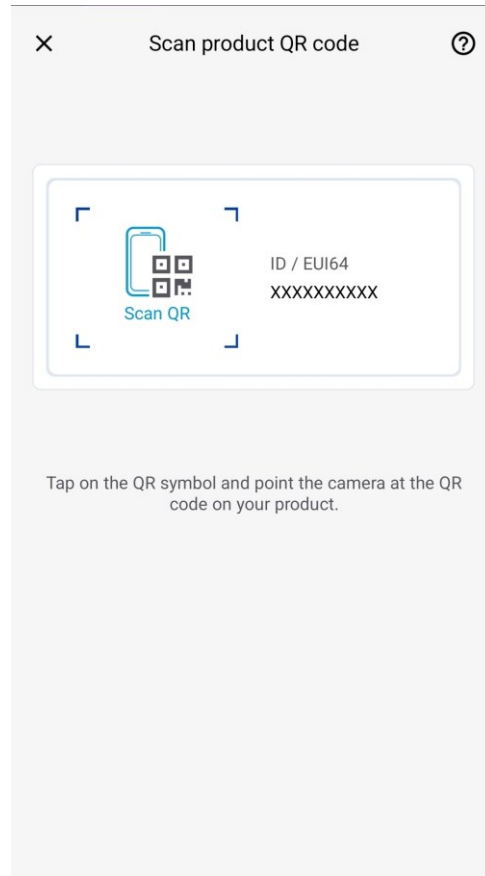

Enter manually

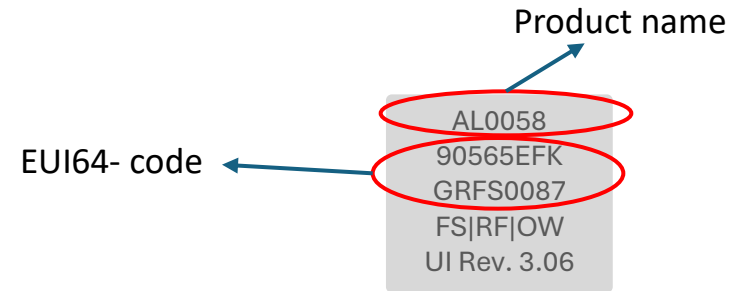

Press and hold the enter button button for 5-10 sec. A screen will show on the device showing the EUI64 code



Press the + symbol in the top right corner

You will now be able to scan or manually enter the EUI64 code

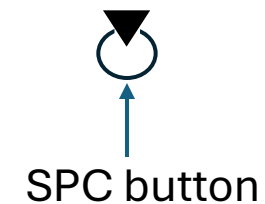
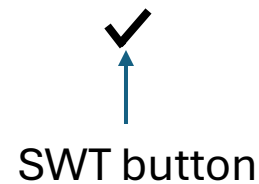

Step3: Enabling Bluetooth



Enable Bluetooth

To enable Bluetooth pairing on your product, press the 'Enter' button to open to the menu.

Navigate through the menu options to select 'Settings' and press 'Enter' again to open the sub-menu.

Select 'Comms' from the options and press 'Enter'.

Select 'BT' and press 'Enter', followed by 'Enable' to enable the Bluetooth. A confirmation screen will be shown, and then the Bluetooth ID and PIN will be displayed for 30 seconds.

Pairing can take a few moments. If prompted for a pairing pin/passkey, please enter the 'PIN' displayed on the UI of your product.

Bluetooth is enabled

After the EUI64 info has been shared, you will be prompted to activate Bluetooth on the device.

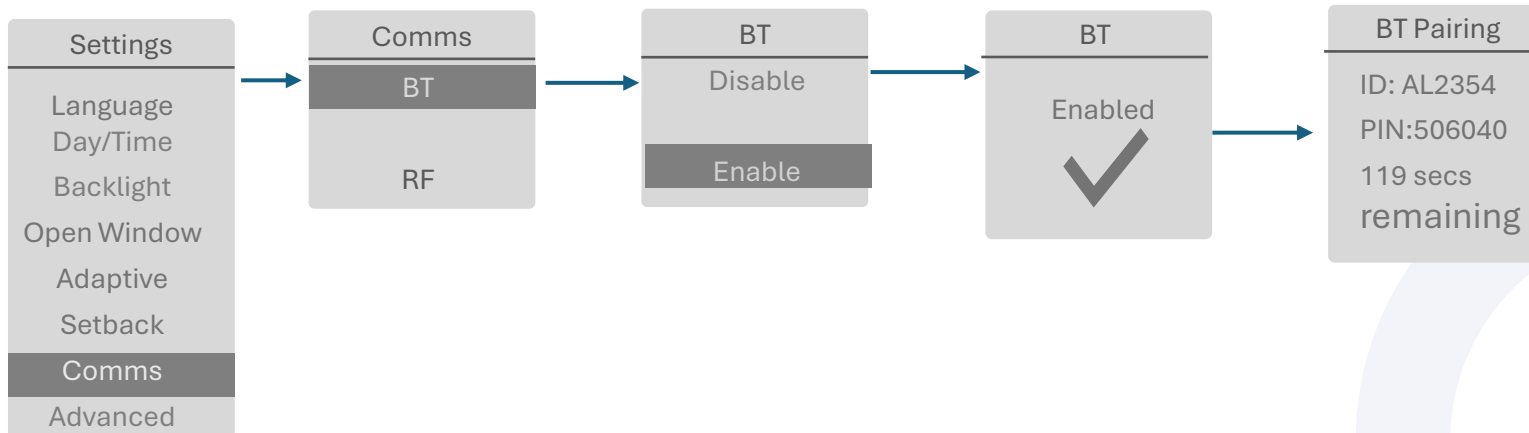

On the device go into settings/comms/BT/Enable

Press the confirmation button, then in the app press Bluetooth enabled

Important: When BT pairing screen is visible, Write down or memorize the PIN. The pin is also located on the sticker that is on the SPC and SWT. This screen disappears when it gets a BT connection with app! The pin is must be inputted on the app when prompted

Step3: Enabling Bluetooth

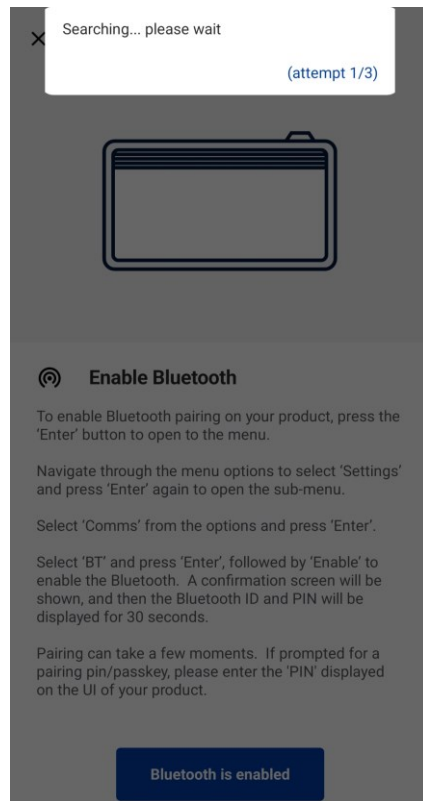

Searching for device

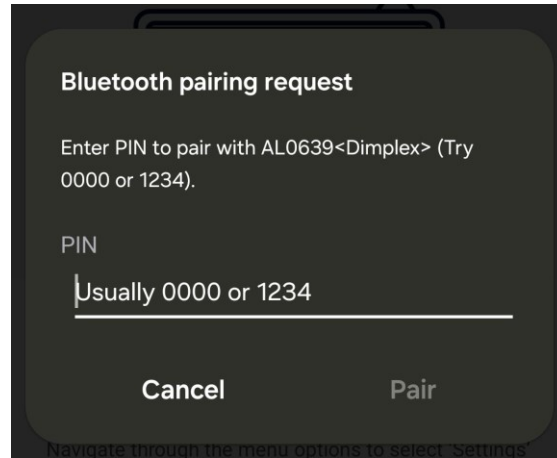

Enter Bluetooth PIN

When the device is paired set the name you wish.

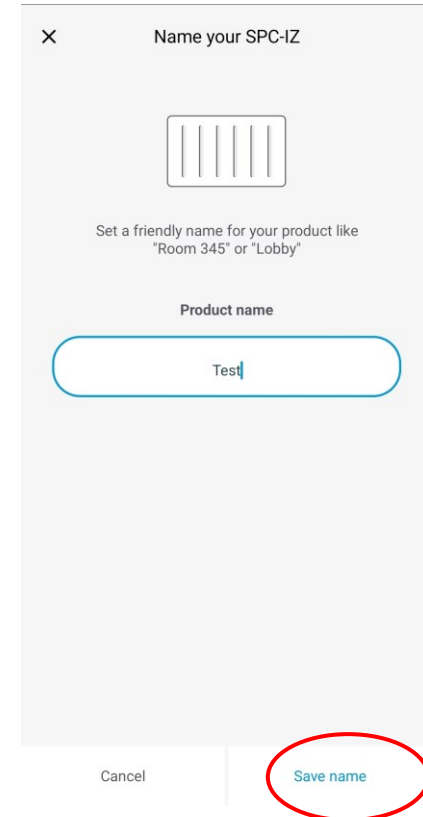

Then press “save name”

Step4: Updating device

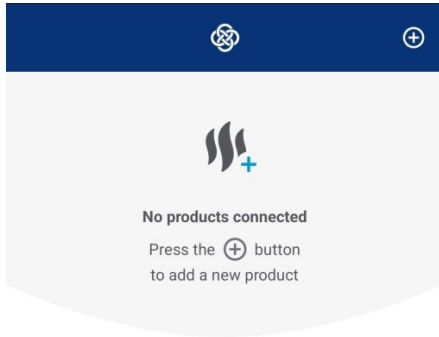

[See all products](#)



From the main menu press products at the bottom.

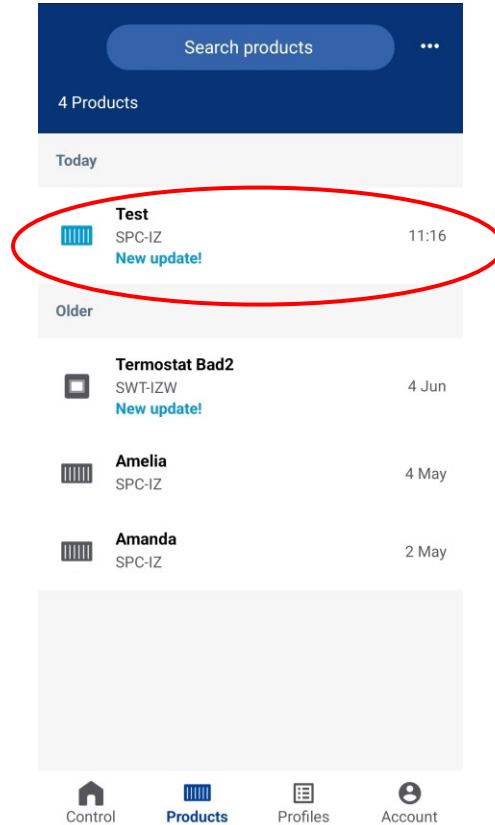

Here you have the list of devices, that has been connected to ConfigR.

And which devices has available Firmware update.

Press on the device you wish to update!

In this example we will use the Test (SPC-IZ) “ press the button for Test(SPC-IZ)

Step4: Updating device

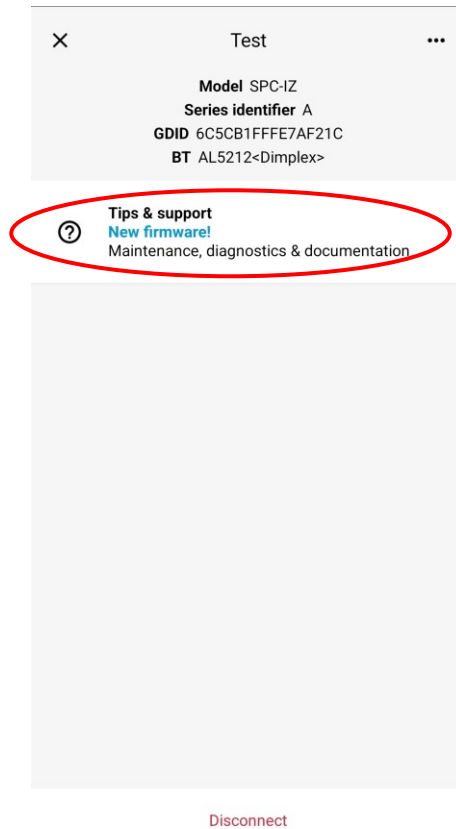

This will show you details about the device. Press the Tips & Support to update

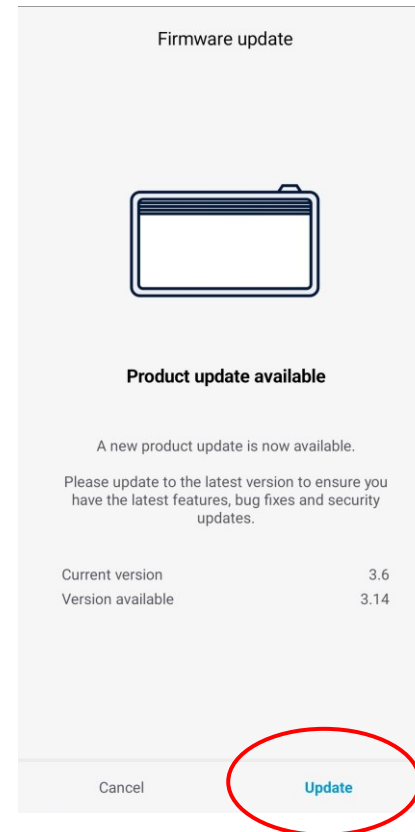

Press the update button, to start the updating process

Step4: Updating device

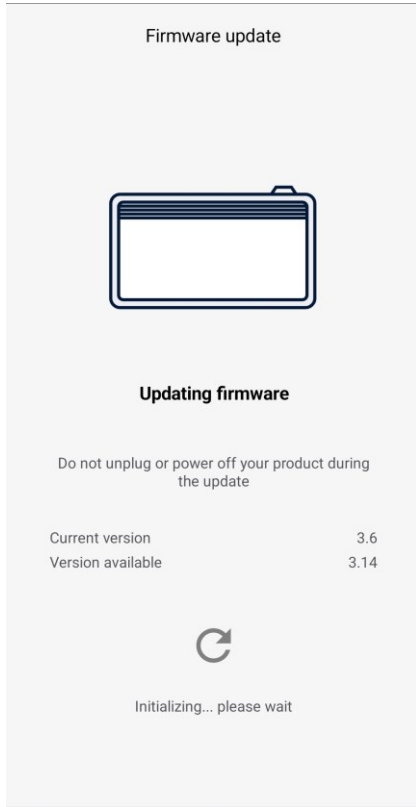

It will now start updating.
Follow instructions

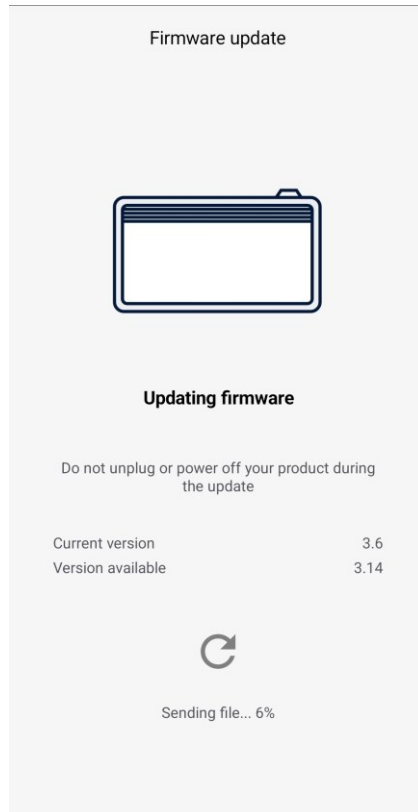

The phone must be in close proximity of the device under update process

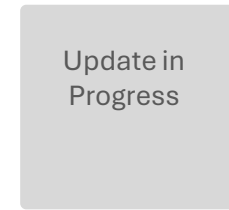
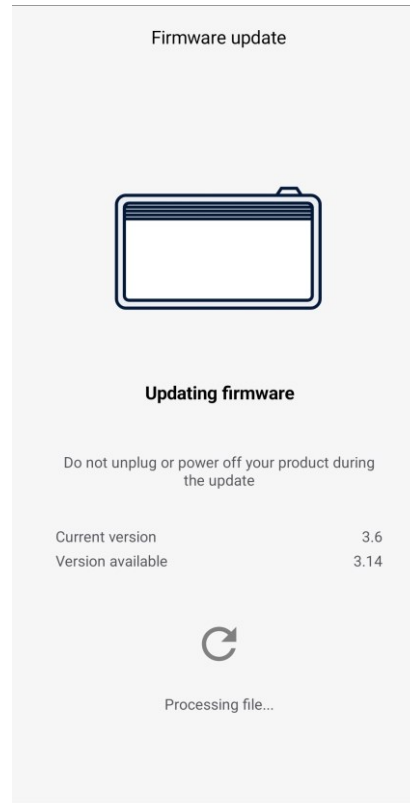

Info screen on device

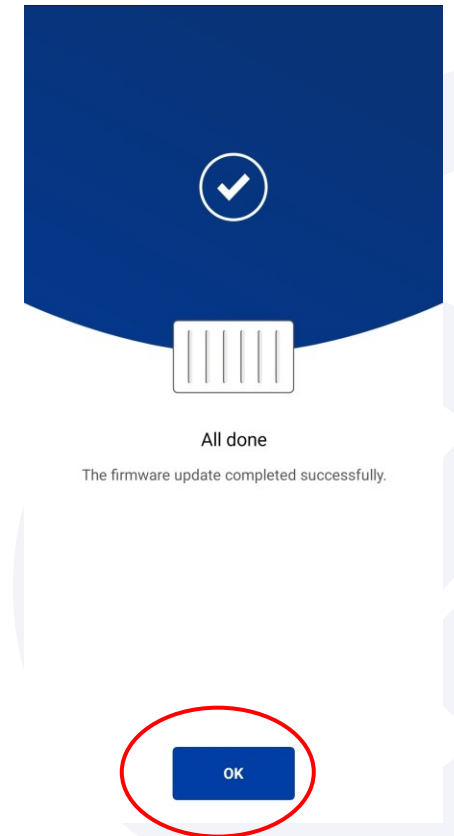

Update done press OK

Step 5: adding it back top the network

Congratulation the device has successfully been updated, you can now add it back in your smart home eco system.

All you have to do is to power off the SPC or SWT and power it back on again before you start the pairing process.

To start the Zigbee Pairing Process please se instruction below

